

MAXXFAN®

INSTALLATION INSTRUCTIONS, INFORMATION AND OPERATING GUIDE

FOR MAXXFAN® Deluxe MODELS

5100KI • 6200KI • 7000KI • 7500KI

5100KI40 • 6200KI40 • 7000KI40 • 7500KI40

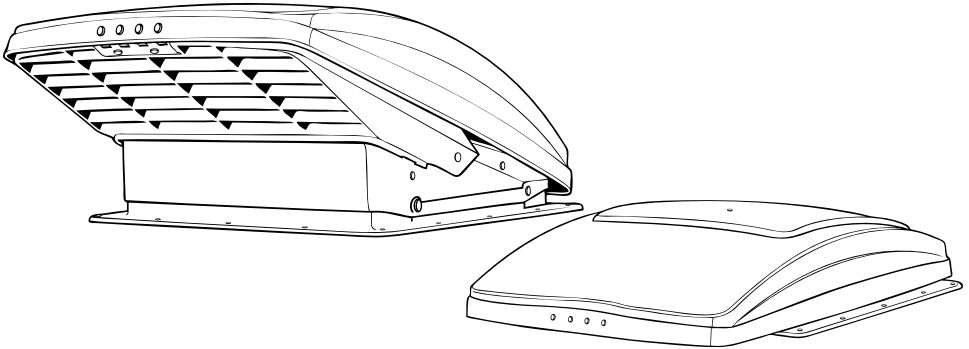

READ AND SAVE THESE INSTRUCTIONS

NOTE: Refer to supplied Operating Instructions regarding the model you have purchased.

The **MAXXFAN** installs into a standard RV roof opening of 355mm x 355mm for KI models and 400mm x 400mm for KI40 models.

To determine if your roof opening is correctly sized, simply remove the interior ceiling garnish trim ring of your existing roof vent and measure the ceiling opening or verify the opening is large enough by sliding the **MAXXFAN** interior garnish trim ring into the opening.

Due to the EXHAUST / INTAKE LOUVERS that face the rear of the vehicle, the **MAXXFAN** requires a roof area clear of obstructions such as air conditioners, storage boxes, etc. for at least 203 mm to the rear of the existing standard roof vent flange outer rear edge.

The **MAXXFAN** is designed for a minimum roof thickness of 25 mm to a maximum of 90mm. If your roof thickness is less than 25 mm, build additional thickness at the ceiling opening using wood or other suitable material.

The **MAXXFAN** is designed for a nominal 12 Volt DC system and requires a circuit capable of supplying a minimum of 5 amps to the MAXXFAN. Confirm that the circuit you intend to use will accommodate the additional load. Use the proper gauge stranded wire for electrical connections.

WARNING! To reduce risk of fire, injury to persons or damage to property, use only in the manner intended by AIRXCEL, INC. Should you have questions, please contact your AIRXCEL/MAXXAIR Distributor.



MAXxAIR
VENTILATION SOLUTIONS

INSTALLATION INSTRUCTIONS - ALL MODELS

STEP 1

MAXXFAN requires a roof opening opening of 355mm x 355mm for KI models and a roof opening of 400mm x 400mm for KI40 models. If you are replacing another type already installed, remove the old existing roof vent. Remove all old roof sealant for a minimum of 50mm entirely around the roof opening.

Place the MAXXFAN Roof Receiving Flange (reference photo #2 below) into the roof opening and trace a pencil line around it to verify the clean seal area that will be required. Note that the Roof Receiving Flange must be centered in the roof opening with the metal clips facing the sides of the vehicle (not facing the front or rear of the vehicle).

CAUTION: When installing your Roof Flange, only use a caulking/sealant compatible with the flange (plastic product) and the roof surface. DO NOT use materials containing solvents such as or similar to Xylene, Toluene, Methyl Ethyl Ketone, Acetate or Acetone as they can damage the flange. Also, Polysulfide (Thiokol) type sealants must be avoided. Silicone Sealants such as G.E. Silicone II (non-paintable) used for outdoor applications have proven to be suitable for this installation.

If in doubt, please contact the manufacturer of your RV for further information.

STEP 2

Apply Sealant or Caulking within the area you have traced on the roof with a pencil. Apply it carefully to avoid gaps that may allow water to enter.

Fasten the Roof Receiving Flange to the roof with screws provided.

Apply additional roof sealant over the screw heads and around the edge of the roof flange.

CAUTION: Disconnect main vehicle power before connecting 12 volt DC power to the **MAXXFAN**!

NOTE: The **MAXXFAN** must be fully opened prior to proceeding to STEP 3. Turn knob to fully raise the vent lid.

NOTE: On the **NON-REMOTE** controlled models, the knob must be pulled out to unlock before turning.

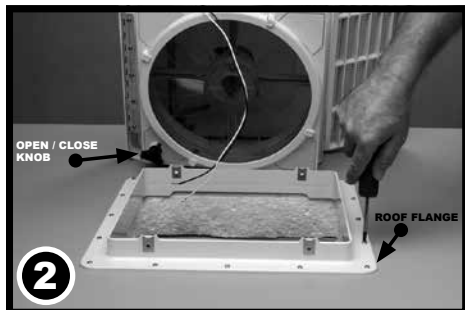

STEP 3

Using the insulated electrical connectors provided, connect the vehicle's 12 volt power to the two MAXXFAN power wires.

NOTE: The MAXXFAN black wire identified with a tag showing (+) must be connected to the vehicle 12 volt (+) positive supply.

CAUTION: Connecting the MAXXFAN to a circuit other than 12 Volts DC or with incorrect polarity could damage the MAXXFAN, cause injury to persons or damage to property and void the warranty.

STEP 4

Confirm the 4 metal mounting clips are firmly in place on the Roof Receiving Flange. With the MAXXFAN open and the exhaust/intake louvers facing the rear of the vehicle, lower the MAXXFAN onto the Roof Receiving Flange.

Make sure the power wires slide to the vehicle interior and do not become entangled on the Roof Receiving Flange's upward edge.

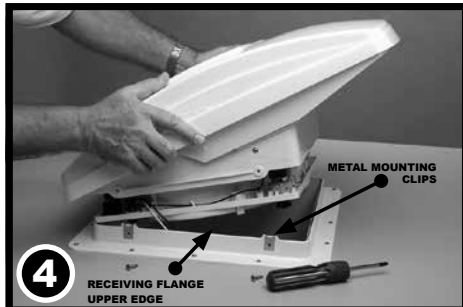

STEP 5

Verify the MAXXFAN is fully seated down on the Roof Receiving Flange and fasten the MAXXFAN to the Roof Receiving Flange using the four 19mm #10 stainless steel screws provided.

CAUTION: Only use the screws provided/specified for this installation or internal damage and/or insecure mounting may result.



THIS COMPLETES THE ROOF TOP PORTION OF THE INSTALLATION

NOTE: Re-apply 12 volt vehicle power. The MAXXFAN will emit a beeping sound to indicate power is properly connected. In addition, the Remote Control model will automatically close the vent cover. If the MAXXFAN does not beep when power is connected, go back to step #3. Confirm that proper connections were made and 12 volt power is on and available. This MAXXFAN incorporates a self-resetting fuse on the circuit board located in the ceiling assembly. It can be reset by removing and re-applying power. If your fan fails to operate or needs reset, contact your AIRXCEL / MAXXAIR Distributor for assistance or solicit the aid of an electrical technician.

STEP 6

The interior Garnish Trim Ring must be trimmed to fit your particular RV roof thickness. To accomplish this, measure the distance from the vehicle ceiling surface to each corner of the MAXXFAN Control Plate.

Most RV roofs have some slope, so measuring each corner is necessary. The Garnish ring should be cut 6mm to 12.5mm longer than the dimensions measured at each corner.

In Picture #6 below, the installation measures 90mm from the ceiling (this is an example only) to the Control Plate. After adding 12mm as in this example, using a ruler, place a mark at 102mm on each corner of each side of the Garnish Ring (refer to 6A, right). Once marked, draw a line connecting all 102 mm marks on the outside of the Garnish ring and trim accordingly (refer to 6B, right).

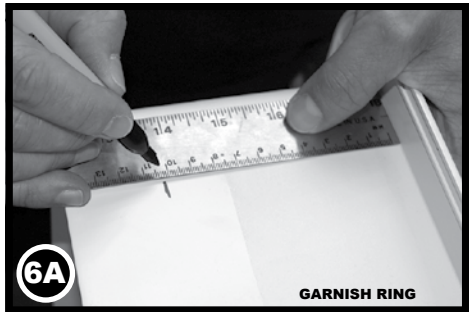
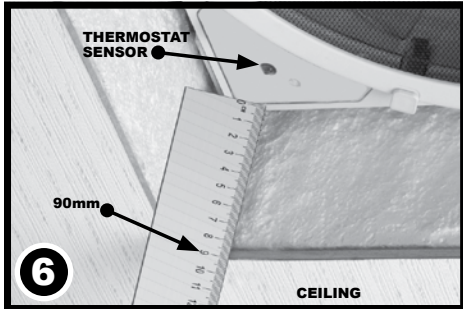

MEASUREMENTS STATED IN STEP 6 ARE USED AS AN EXAMPLE FOR ILLUSTRATION PURPOSES ONLY

NOTE: DO NOT probe or tamper with the thermostat sensor or IR sensor shown in illustration #6 above.



STEP 7

Complete the installation by placing any excess wiring to the inside of the roof opening and sliding the Garnish Ring into position. Fasten in place by using the four painted flat head screws provided.

CONGRATULATIONS!!!

You have successfully completed the installation of your new **MAXXFAN**.

If you have questions, please visit AIRXCEL.com or contract your AIRXCEL / MAXXAIR Distributor.



FOR REMOTE CONTROL MODELS: Refer to the Operating Instructions for use and testing of your remote control. Install the two AAA batteries included, follow instructions, aim remote at the ceiling unit and test your fan. The Remote Control comes with a cradle for wall mount storage of the Handheld Remote Control. Mount the cradle to your wall using the (2) #6 screws provided. Remote may be placed into the wall cradle for storage.

MAXXFAN® 1 YEAR LIMITED WARRANTY

AIRXCEL, INC. - RV PRODUCTS DIVISION / MAXXAIR Ventilation Solutions warrants to be free of manufacturing defects, regardless of ownership for a period of one (1) year from the original date of purchase. **You must keep your original sales receipt.** This **Limited Warranty** does not include "Acts of God," failure due to misuse, improper installation or accidental / incidental damages. Please call your AIRXCEL / MAXXAIR Distributor if you have any questions or need assistance. **Please have your original sales receipt and MAXXFAN Serial Number readily available.** This limited warranty does not cover labor or any freight costs for the return of the product to or from AIRXCEL, INC. or costs associated with installation, removal or reinstallation of the product.

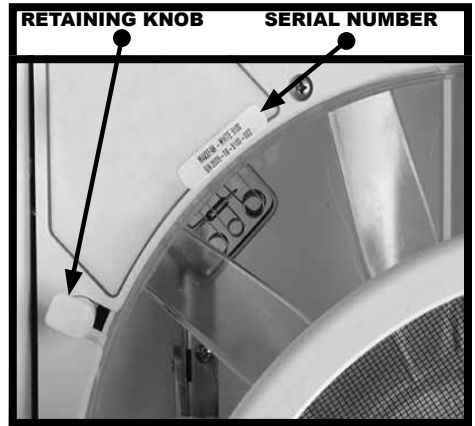

For WARRANTY INFORMATION on products purchased in Australia or New Zealand, please visit www.CoastRV.com.au • www.coastrv.co.nz

The Serial Number for your MAXXFAN is located on the fan control plate under the round insect screen frame. Actual location may differ from image shown. Reference your operating guide. Rotate the four retaining knobs 180° and remove the screen to view. DO NOT OPERATE the MAXXFAN with the screen removed.

CAUTIONS AND CARE OF YOUR MAXXFAN®

This product has been manufactured using prime UV stabilized Polymers for maximum toughness and durability. However, the use of caustic or solvent based chemicals can cause cracking and product failure.

PLEASE CLEAN ALL PARTS WITH MILD SOAP AND WATER ONLY.

Do not use Petroleum Containing Additives or Solvent Based Products on any of the MAXXFAN's components or its corrosion resistant hardware.

LISTED BELOW ARE SOME KNOWN CHEMICAL PRODUCTS TO BE AWARE OF:

NON COMPATIBLE CHEMICALS - DO NOT USE THESE:

Ketones, Esters, Acetone or other like solvents, Halogenated Hydrocarbons, Amines, Aromatic Hydrocarbons, (Loctite Formulas), or any products containing references to: chemicals that are not to be used on plastics.

GENERALLY COMPATIBLE (But should be used in low concentration where possible)

Acids, Alcohol, Alkalies, Aliphatic Hydrocarbons, Mild Soap Solution (avoid strong Alkaline Material), Silicone Oil or Greases (avoid those containing Aromatic Hydrocarbons or other additives). Review the contents of your cleaning materials carefully.

*For additional information regarding your **NEW MAXXFAN Deluxe**, please refer to the **INFORMATION AND OPERATING GUIDES** for your particular model on the following pages.*

INFORMATION AND OPERATING GUIDE

FOR MAXXFAN® Deluxe MODELS

5100KI • 6200KI • 7000KI • 7500KI

5100KI40 • 6200KI40 • 7000KI40 • 7500KI40

KNOB, VENT LID OPEN/CLOSE

Manual Opening Models

Pull to unlock prior to turning. Rotate Knob clockwise to Close Vent Lid; Rotate Knob counter-clockwise to Open Vent Lid. Push "IN" to lock when Vent Lid is open or closed.

Automatic Opening Models

Allows closing of the vent lid in the event of RV power loss. This knob does not lock. Do not push in or pull out. Rotate knob clockwise to close vent lid; rotate knob counter-clockwise to open vent lid.

Do not use excessive force when operating Knob.

KEYPAD CONTROLS

Use Keys on Keypad to control MAXXFAN functions (see descriptions on next page).

INSECT SCREEN RETAINER KNOB

Rotate all 4 knobs 1/2 turn to remove screen.

Caution: Never operate fan with screen removed

THERMOSTAT TEMPERATURE SENSOR

CEILING FAN MODE

With the fan motor running, close the Vent Lid to enter Ceiling Fan Mode. The fan motor will continue to run and circulate air within the RV cabin.

SERIAL NUMBER LABEL

The serial number label is located underneath the round insect screen.

NOTE: The MAXXFAN is designed to be fully opened or fully closed when the vehicle is moving.

CAUTION: When removing screen for cleaning, turn the MAXXFAN OFF and remove the vehicle 12 volt power to the MAXXFAN. When cleaning your MAXXFAN, use only a mild detergent solution.

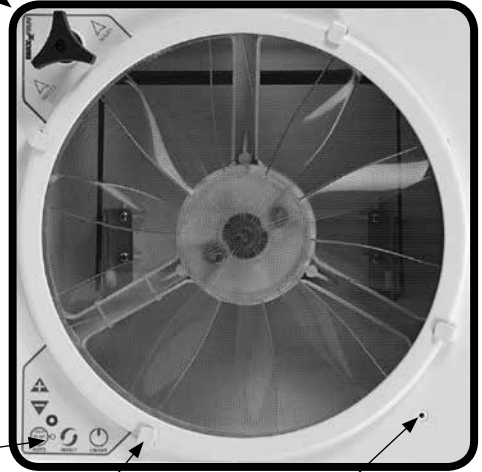

KEYPAD CONTROLS

FOR

MAXXFAN® Deluxe MODELS

5100KI • 6200KI

7000KI • 7500KI

5100KI40 • 6200KI40

7000KI40 • 7500KI40

NOTE: A beeping sound will confirm each key press

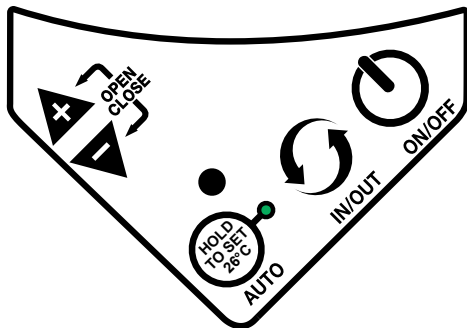

ON/OFF

ON/OFF: Use this key to

start the fan or to turn off the fan. On Automatic Opening Models the lid will also open or close when the fan is turned on or off. On Manual Opening Models pushing this key while in Auto Mode will exit Auto Mode, turn off the fan and the lid will stay in the position you selected. On Automatic Opening Models this button will exit Auto mode, turn the fan off, and close the lid.



IN/OUT

IN/OUT: Use this key to reverse the direction of the fan, the fan will slow down and pause for two (2) seconds before resuming operation in the opposite direction. **Note:** In Auto Mode the fan direction is automatically positioned to Exhaust, but may be overridden and changed to Intake by depressing this key. **Note:** Some models are Exhaust Only. On these models this key is deleted.

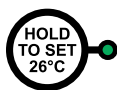

AUTO

AUTO: Auto Mode allows the thermostat to turn the fan **ON and OFF** depending on the thermostat setting. Press this key once for less than three (3) seconds to enter Auto Mode, three (3) quick beeps will confirm the MAXXFAN has entered Auto Mode. To EXIT Auto Mode, press the **ON/OFF** key. Initial factory set point for the thermostat is 26°C. The green LED will light to indicate the MAXXFAN is in Auto Mode. To adjust, follow instructions below:

If no previous thermostat temperature was entered, or you wish to change a previous set temperature, press the HOLD TO SET key for more than 3 seconds and you will hear one long beep and the thermostat will be reset to 26°C. To further adjust the set temperature, if desired, use the (+) or (-) Arrow keys to adjust at 0.5°C increments per press. The fan will emit a beeping sound to confirm this setting. If a previous thermostat temperature was entered, the fan will remember this temperature setting and the next time you enter Auto Mode, the fan will start ventilating automatically as directed by the thermostat. The fan speed will automatically adjust based on the cabin temperature. As cabin temperature rises, the fan increases in speed. **Note:** If 12 volt RV power is removed from the MAXXFAN, the thermostat will be reset to 26°C.

ARROW



When in Auto Mode: Use the (+) & (-) Arrow keys to adjust the thermostat set temperature up or down in 1° increments per press.

When in Manual Mode: Use the (+) & (-) Arrow keys to adjust the fan speed up or down. When the fan speed reaches either the maximum or minimum speed, the fan will respond with 2 quick beeps to indicate this.

ARROW KEYS PRESSED TOGETHER: *Automatic Lift Models Only*

Press the (+) & (-) Arrow keys at the same time to Open or Close the lid. The fan motor will remain in its current state.

REMOTE CONTROL OPERATING GUIDE

WIRELESS REMOTE CONTROL FOR MAXXFAN® Deluxe MODELS

7000KI • 7500KI • 7000KI40 • 7500KI40



FAN
ON/OFF

FAN ON & POWER OFF - Press this button:

- To start the fan
- To turn the fan off
- To exit Auto Mode



VENT LID POSITION - Press this button to open or close the vent lid

• While the fan is running in Manual Mode press once to close the vent lid and enter "Ceiling Fan" Mode.

NOTE: This button is not active in Auto Mode. If the fan loses 12volt RV power or power is removed from the fan, use the knob located at the ceiling to manually open or close the vent lid if desired.



AIR EXHAUST / INTAKE - Press this button to reverse the fan from intake or exhaust

NOTE: In Auto Mode, the fan direction is automatically positioned to Exhaust, but may be overridden and changed to Intake by depressing this key.



FAN AUTO MODE - Press this button to enter Auto Mode

• Auto Mode allows the fan lid to automatically open and the fan motor to operate as dictated by the thermostat set point temperature. Once the cabin temperature cools and reaches the set point temperature, the fan lid will close and the fan motor will shut off.

• Pressing this button while in Auto Mode will shut off Auto Mode, close the vent lid and shut off the fan motor.



THERMOSTAT SET TEMPERATURE

TEMP + ~ Press this button to increase the Set Temperature for Auto Mode.

TEMP - ~ Press this button to decrease the Set Temperature for Auto Mode.

NOTE: The thermostat temperature range is from -2°C to 37°C. To change from Celsius to Fahrenheit on the temperature display, press and hold both set temperature keys simultaneously.



FAN SPEED

Fan Speed UP ~ Press this button to increase the fan speed. The fan has ten speeds.



Fan Speed - ~ Press this button to decrease the fan speed. The fan has ten speeds.

NOTE: When the fan speed reaches either the maximum or minimum speed, the fan will respond with 2 quick beep sounds to indicate this.

Remove protective film from
Display Screen

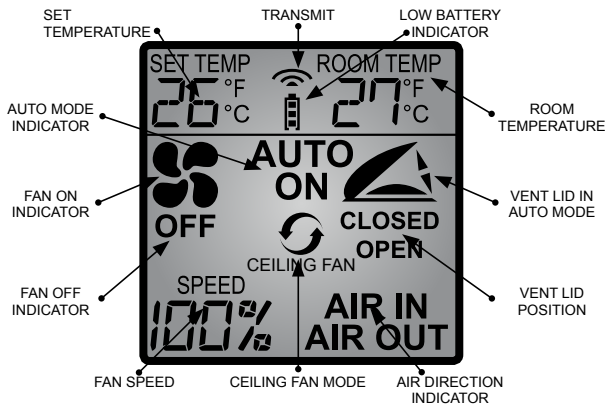

LOW BATTERY INDICATOR

- When the battery is at full charge, three black power bars are displayed.
- One or zero power bars displayed indicates the batteries need replacement.



TRANSMISSION SIGNAL

- This symbol is displayed on the screen when any button is pressed to indicate the signal was transmitted to the fan.
- A beep sound from the ceiling unit indicates the signal from the remote control was received by the fan.